

PROJETO DE COBERTURA METÁLICA - REFORMA E AMPLIAÇÃO DO CAMPO CÓI

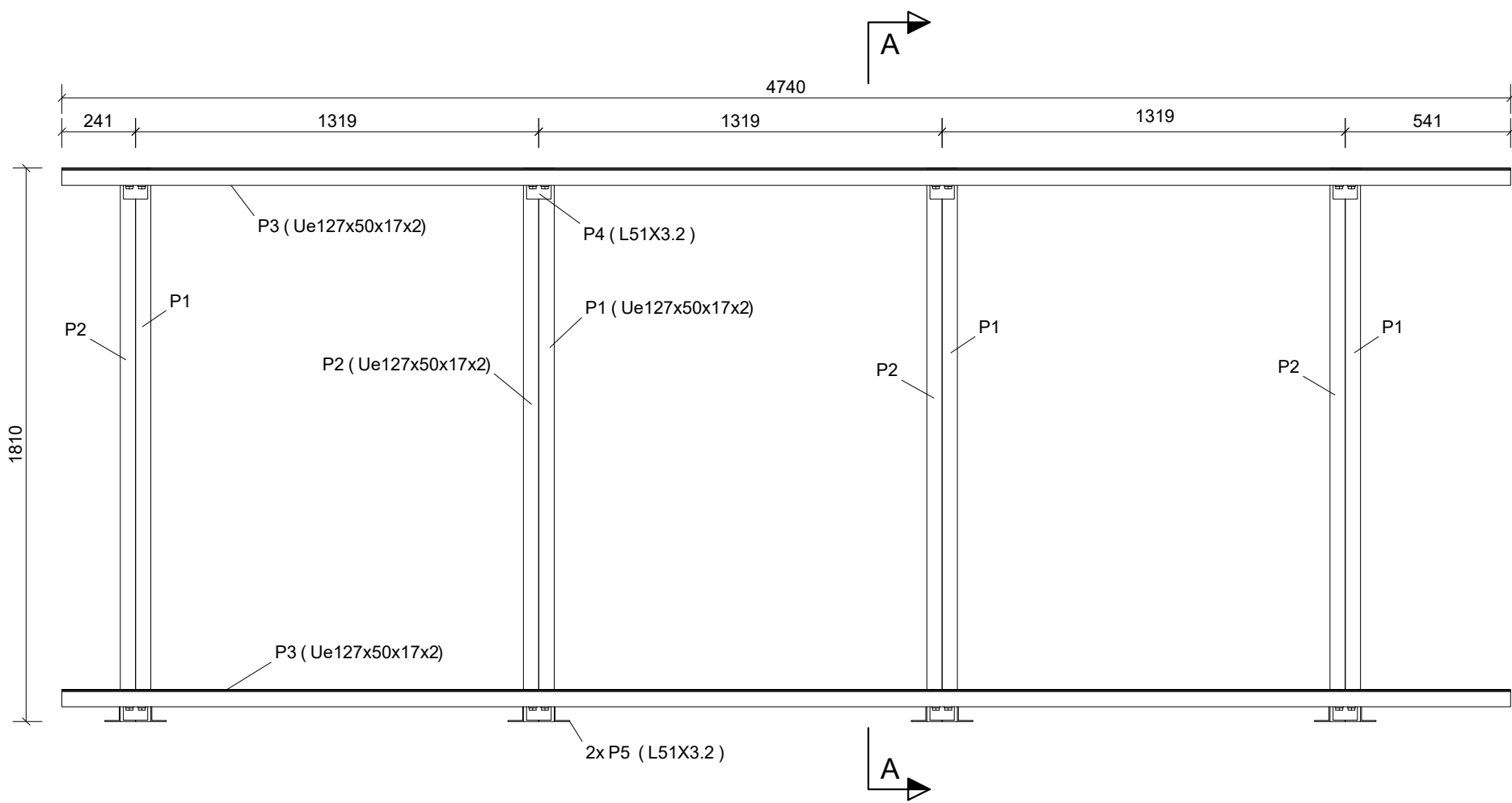

VISTA SUPERIOR  
ESCALA 1:20

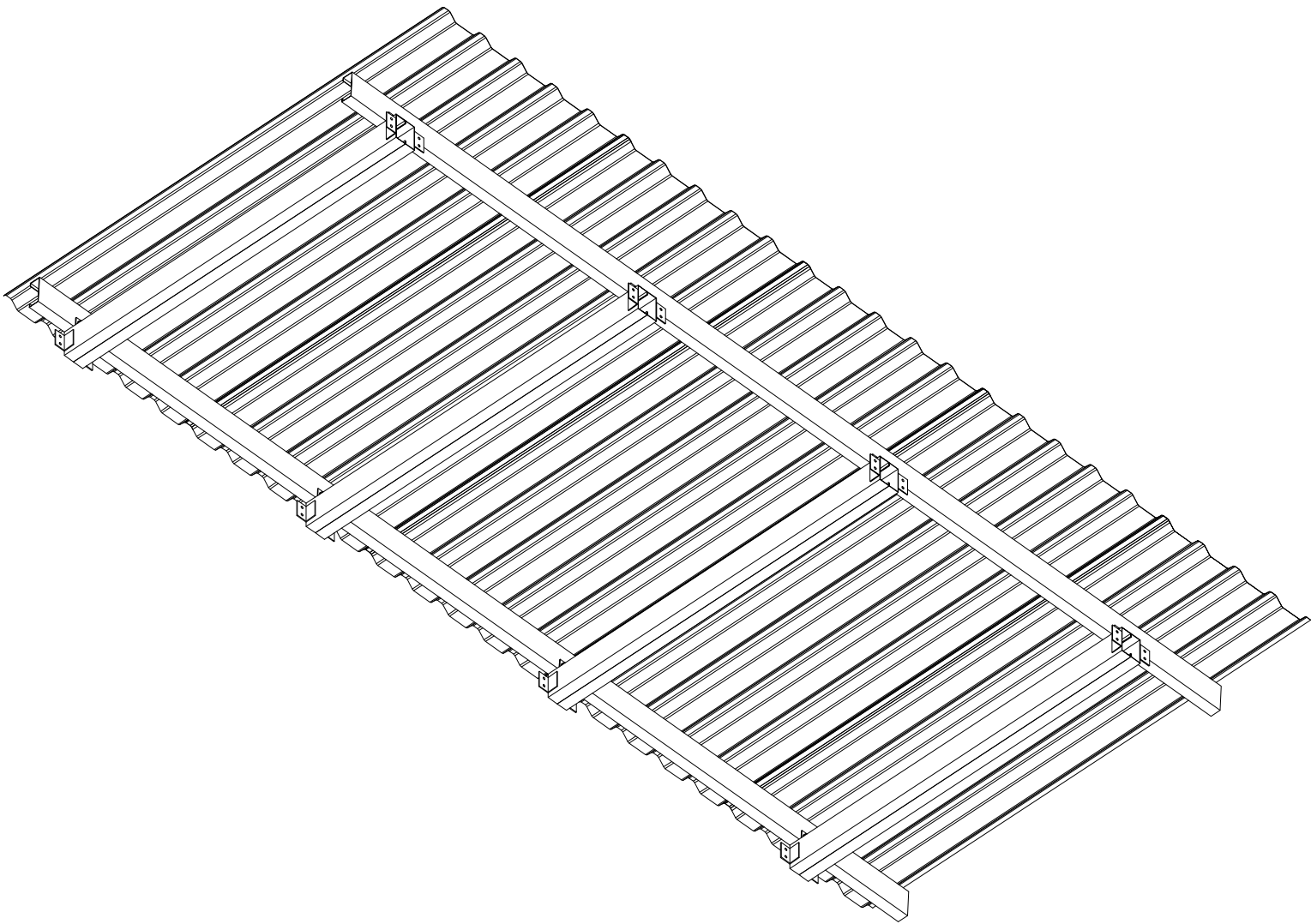

VISTA ISOMÉTRICA  
ESCALA 1:25

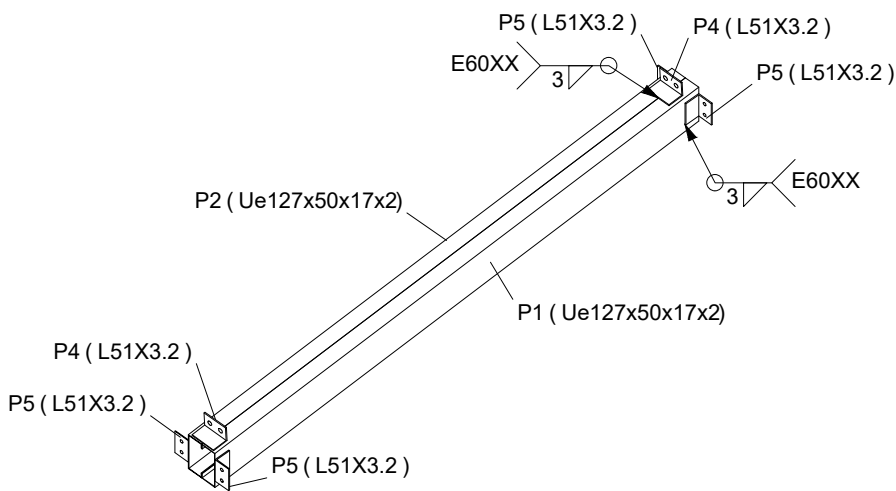

DETALHE: FIXAÇÃO DA TESOURA  
ESCALA 1:20

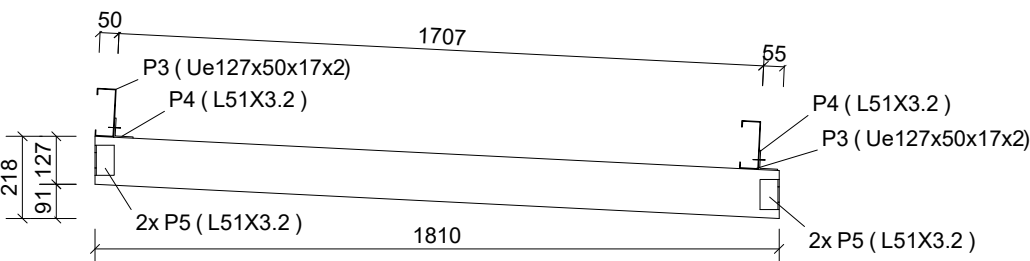

CORTE A - A  
ESCALA 1:20

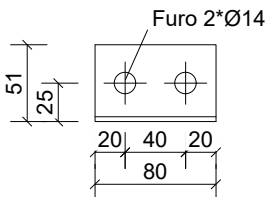

PEÇA P4  
ESCALA 1:5

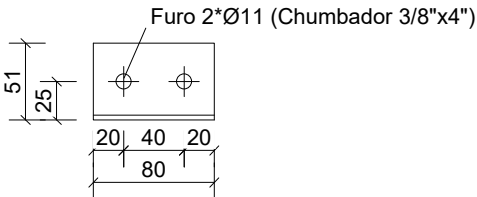

PEÇA P5  
ESCALA 1:5

LISTA DE MATERIAL							
POS	QTD	DESCRIÇÃO	COMP.(mm)	MATERIAL	PESO (kgf)		SUP. (m2)
					UNIT.	TOTAL	
C1	2	TERÇAS			18.8	37.7	4.8
P3	2	Ue127x50x17x2	4740	SAE 1020	18.8	37.7	4.8
C2	4	TESOURAS			15.6	62.3	7.8
P1	4	Ue127x50x17x2	1818	SAE 1020	7.2	28.8	3.7
P2	4	Ue127x50x17x2	1818	SAE 1020	7.2	28.8	3.7
P4	8	L51X3.2	80	A36	0.2	1.6	0.1
P5	16	L51X3.2	80	A36	0.2	3.2	0.1
PESO TOTAL = 100.0 kg							
				SUPERFÍCIE A TRATAR:		12.6 m²	

NOTAS:  
COTAS EM MILÍMETROS;  
PERFIS SOLDADOS COM ELETRODO E60XX  
ÁREA DE TELHA METÁLICA TRAPEZOIDAL ESP.: 0,50 MM = 12,12 M²  
32x CHUMBADORES 3/8" x 4"  
16x PARAFUSOS 1/2" X 1.1/2"  
16x PORCAS 1/2"  
32x ARRUELAS 1/2"
